

Macro-Lab

Team Design Project

Group 8

Spring 2006

Felicia Ouyang, Kristin Tso, Jessica
Rifkind, Anirudh Vemprala, Vanitha
Virudachalam, Peng Xu

Blurring the lines

- * Create an atmosphere that reflects the users of the lab, both past and present
- * Encourage designers to think more about the people for whom they are designing

Create a space

where:

- * Group work is facilitated
- * Innovation is encouraged
- * Many disciplines collaborate
- * Users are comfortable

for:

- * Current students, potential donors, and prospective students

which is:

- * Maintainable and sustainable
- * Affordable
- * Minimally supervised

What they said

26 people rated current spaces

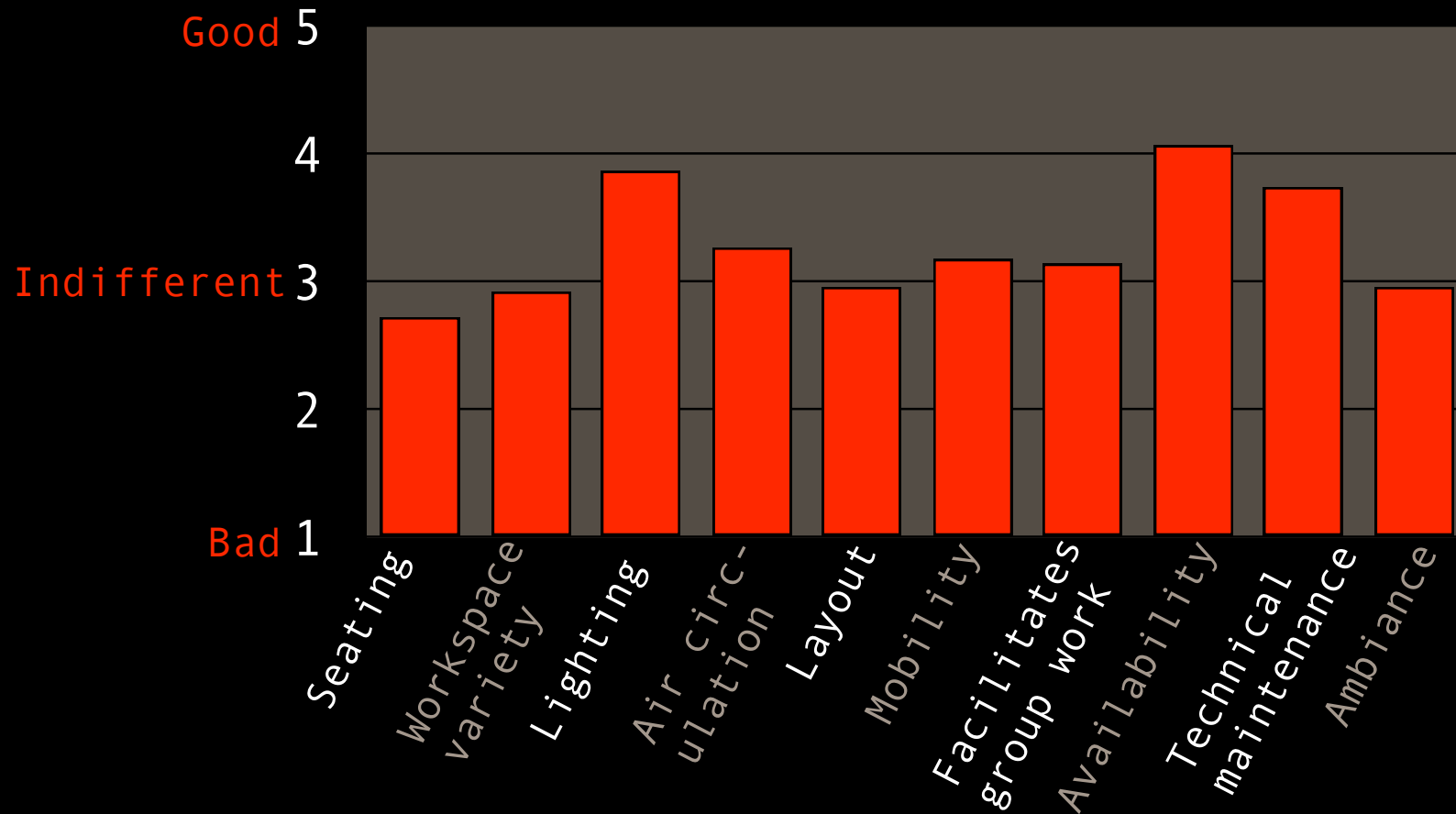

Level Two

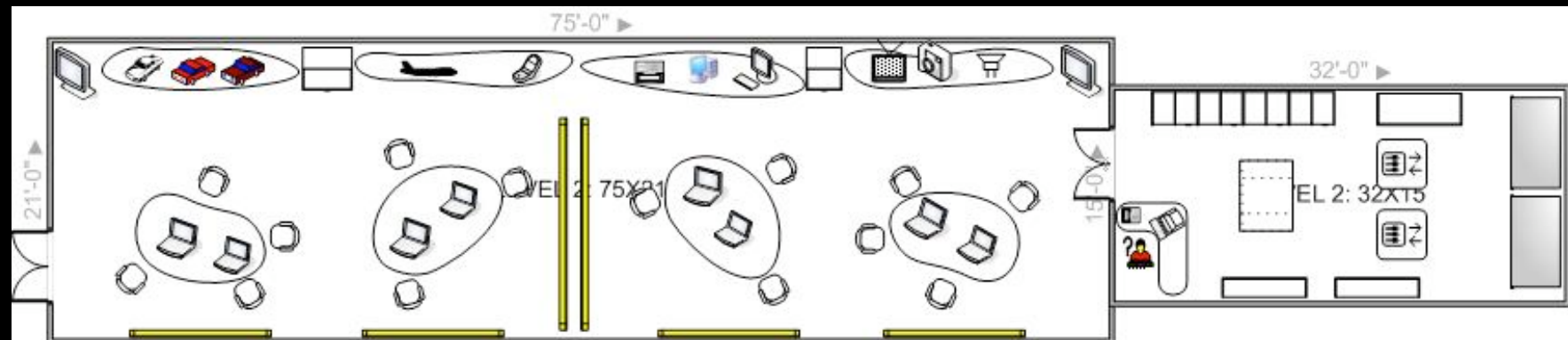

Level Two



Design Continuum

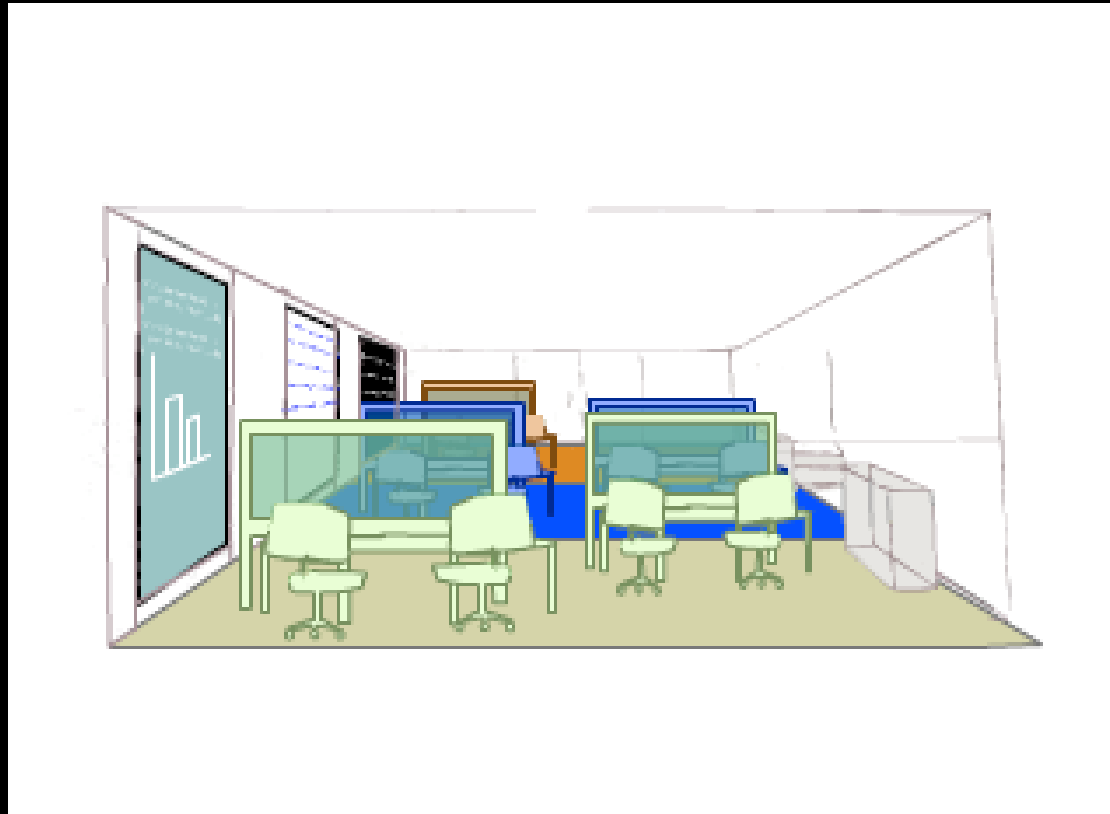

animation sequence

Group Work & Displays

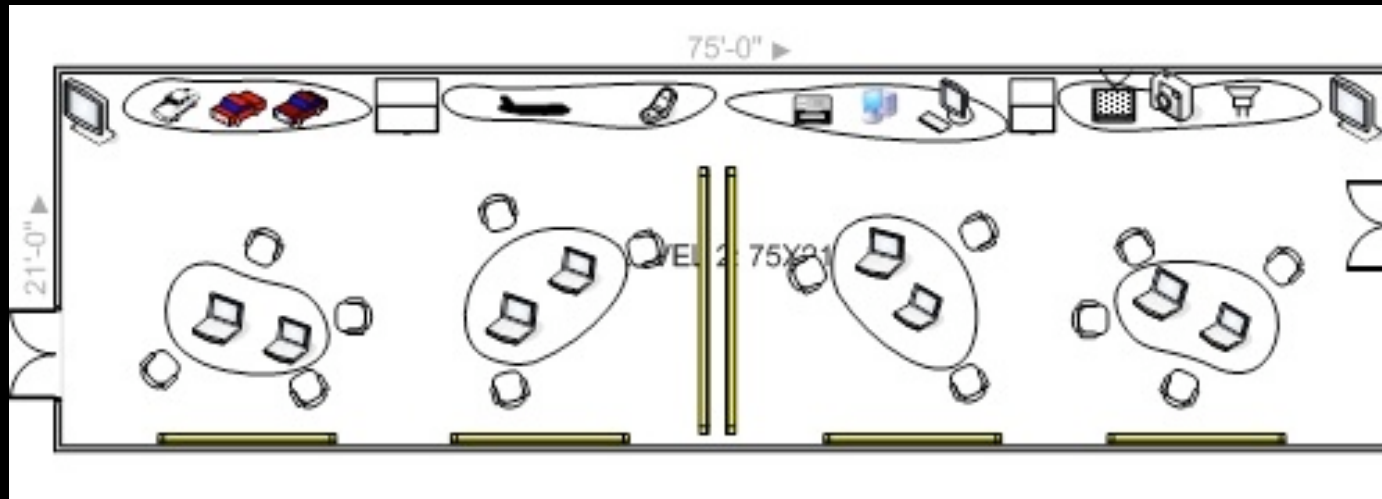

- * Facilitates team work
- * Exhibits and continuum draw people in from cafe
- * Sensors record real-time information of lab usage

Instant Feedback

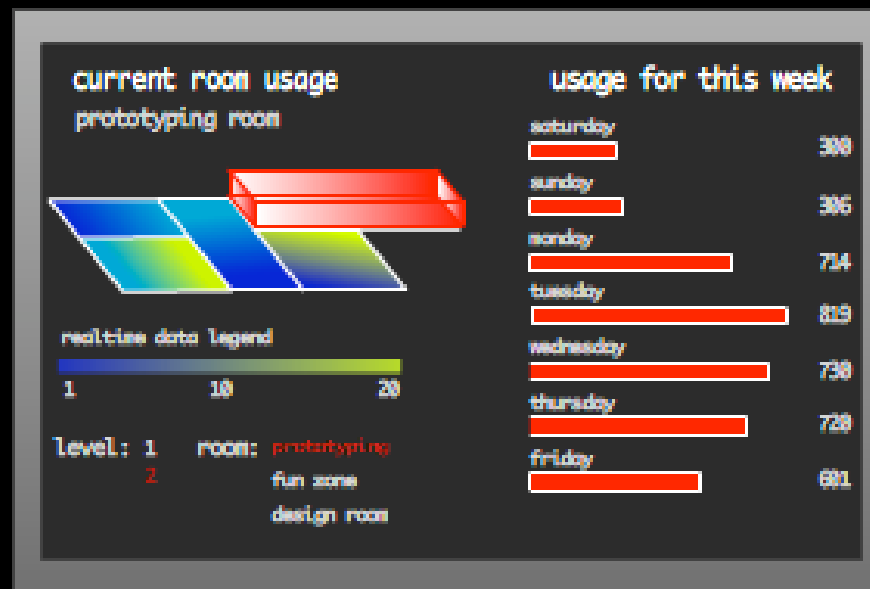

animation sequence

Hallways



Images courtesy of <http://www.fredericeyl.de/aperture/>

- * Iris diaphragm installation in hallways
- * Displays silhouettes of people walking through, currently and past

Level Two

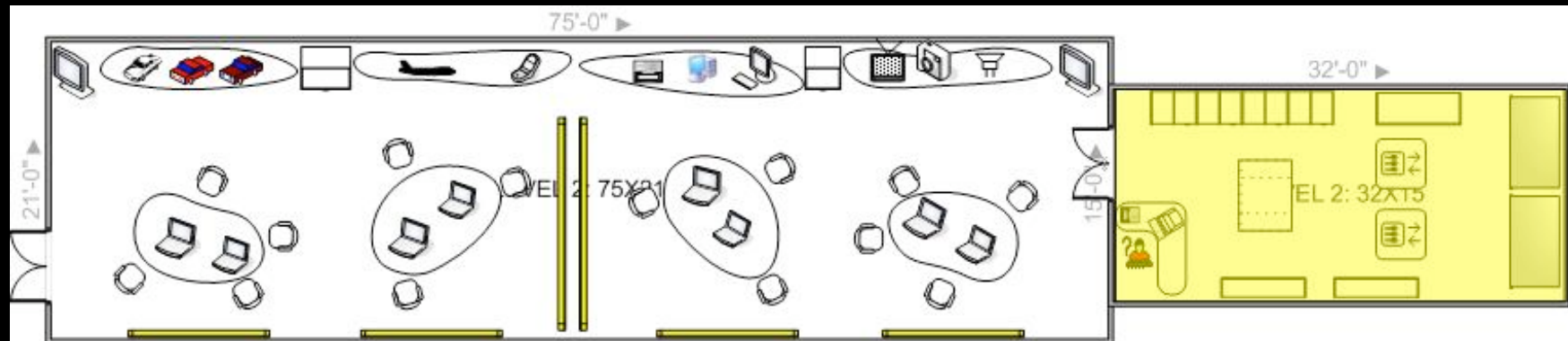

Storage & Rentals

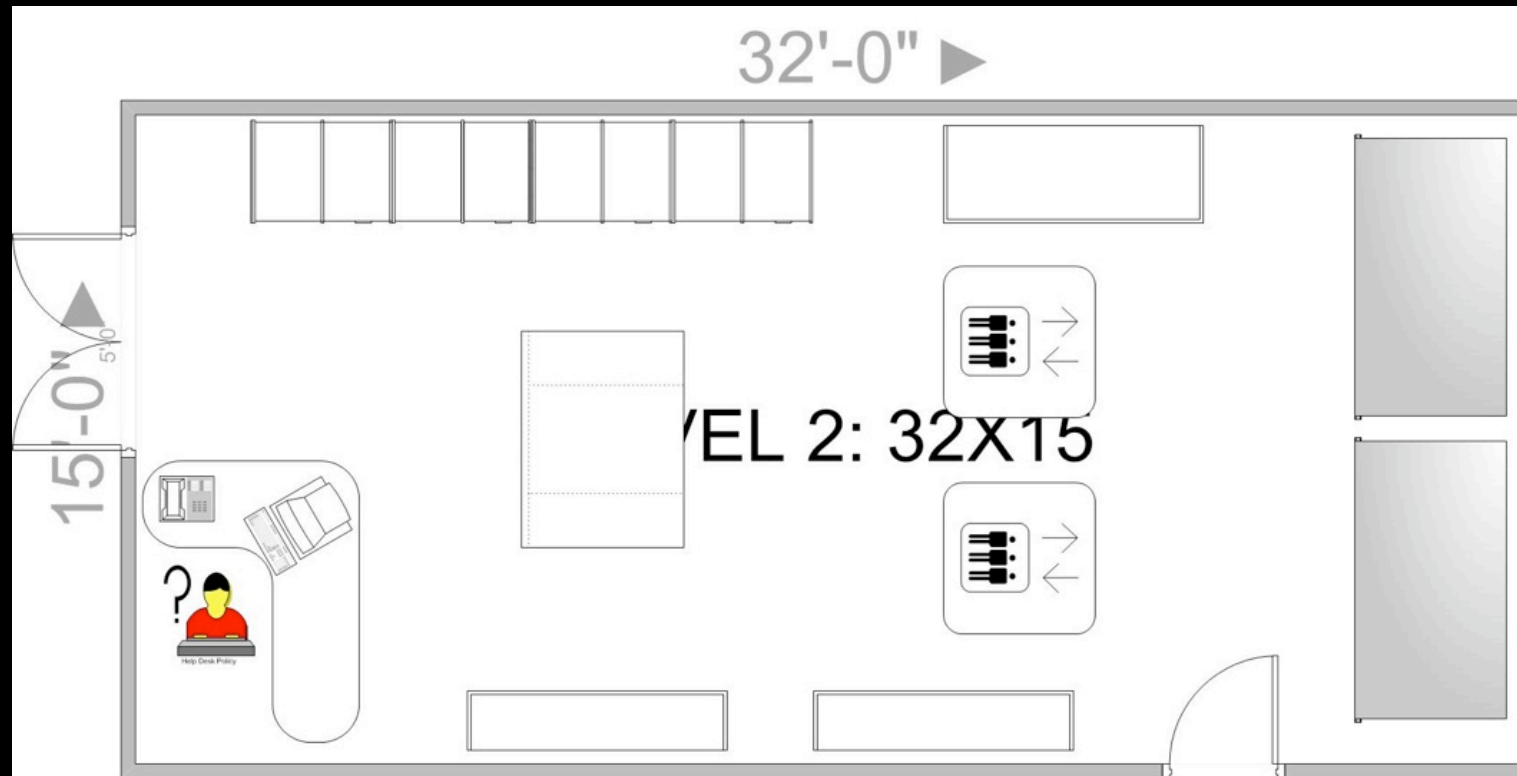

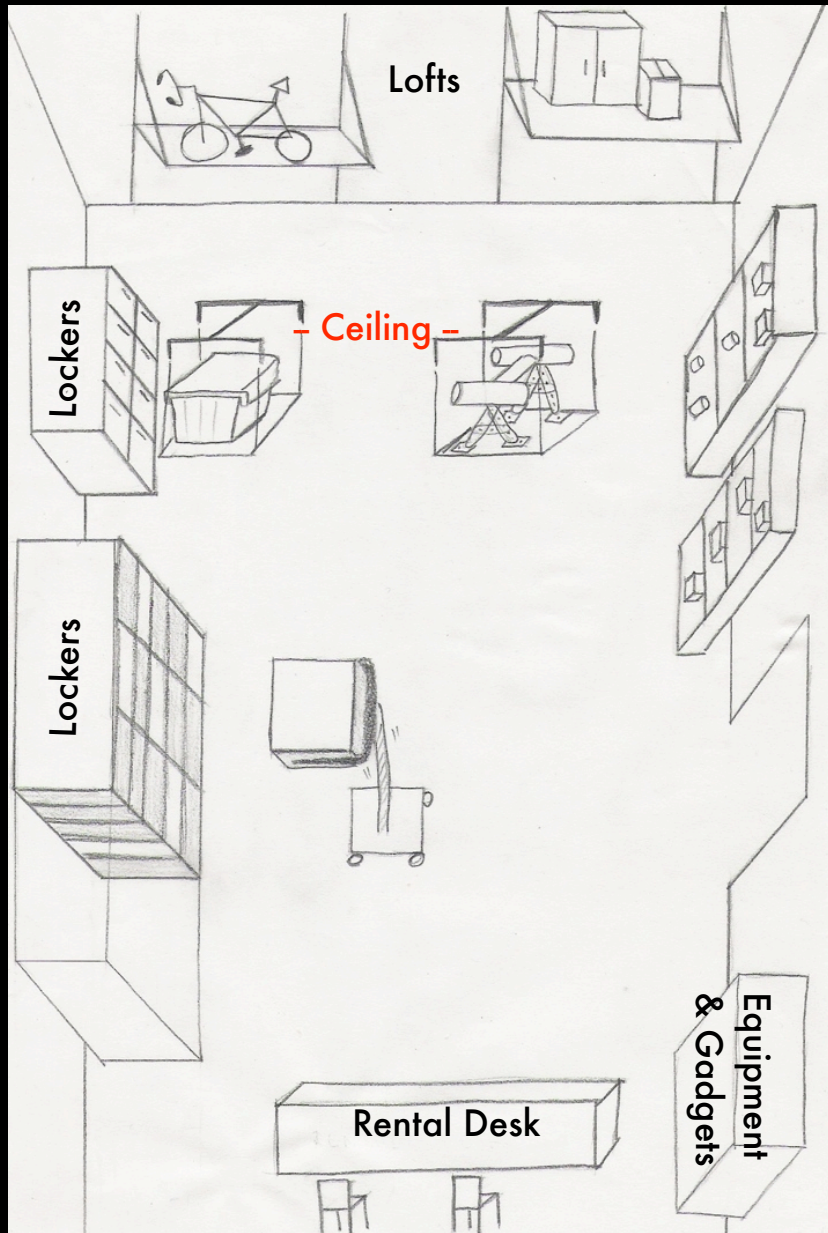

- * Variety of options

- * Ergonomic!

- * Gadget rentals

Level One

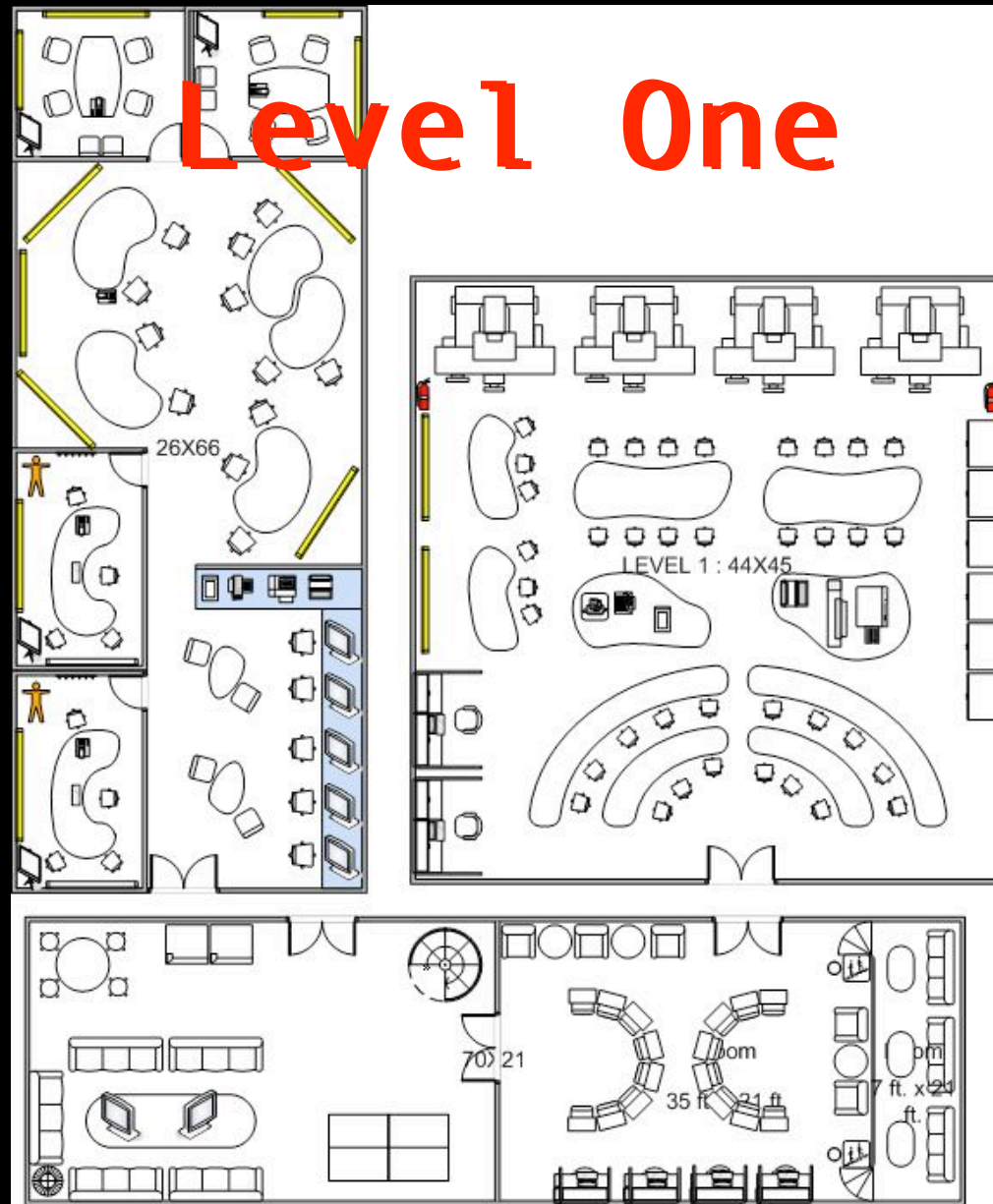

Level One



Study Lounge/**Fun Zone**

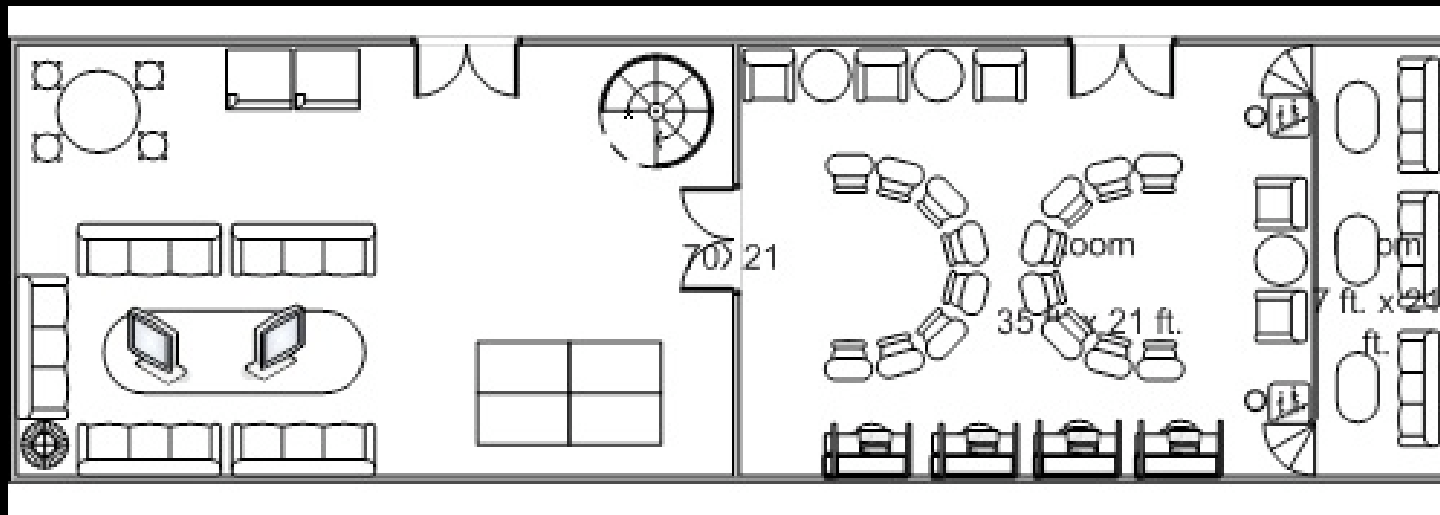

Fun Zone

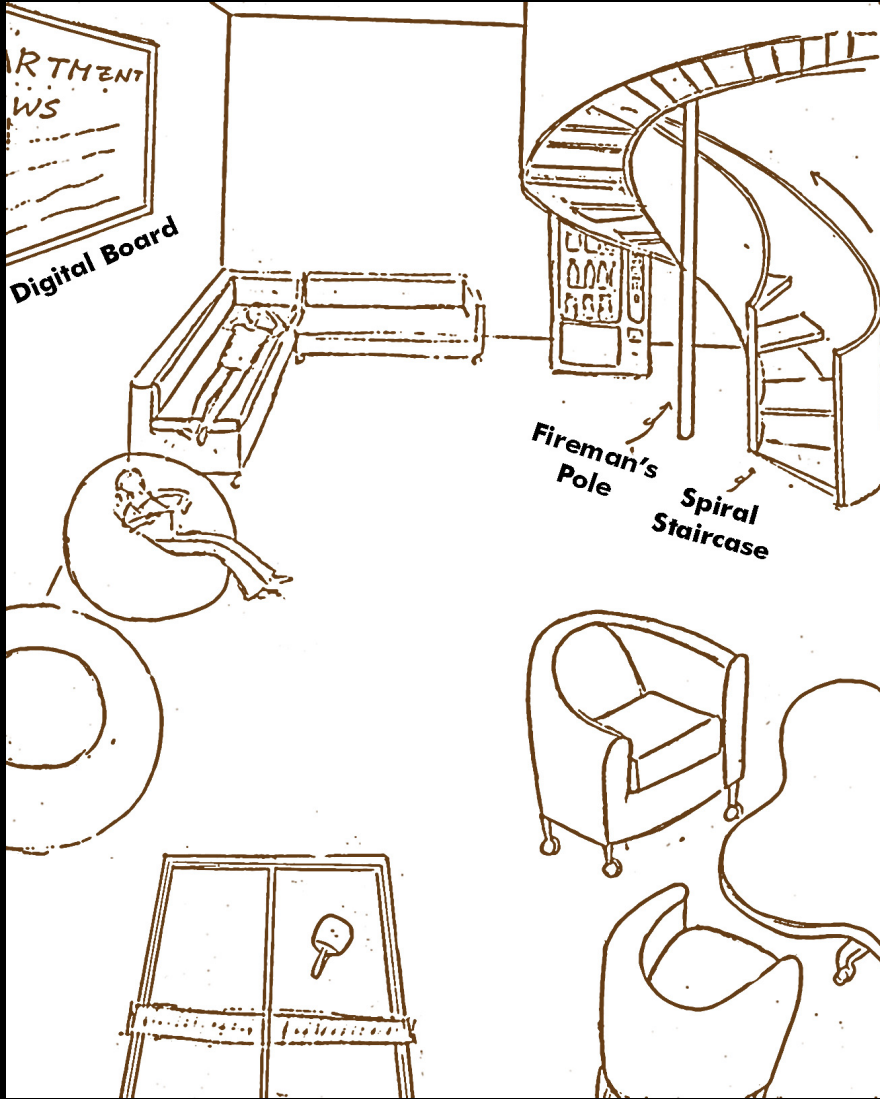

Couches

personal + group

Games

ping pong
foosball
pool

Fun/Inspiring Elements

fireman's pole
spiral staircase

Vending Machines

Digital Screen

relaxing image
announcements
movie

Moving on...

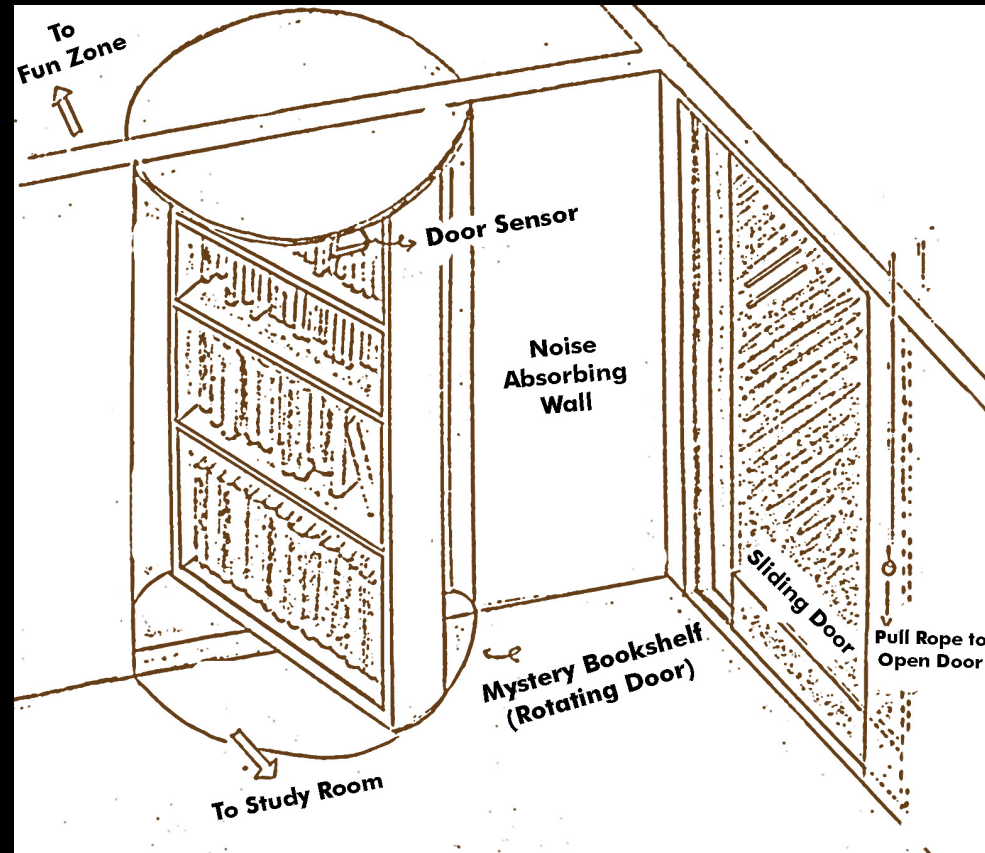

Study Lounge

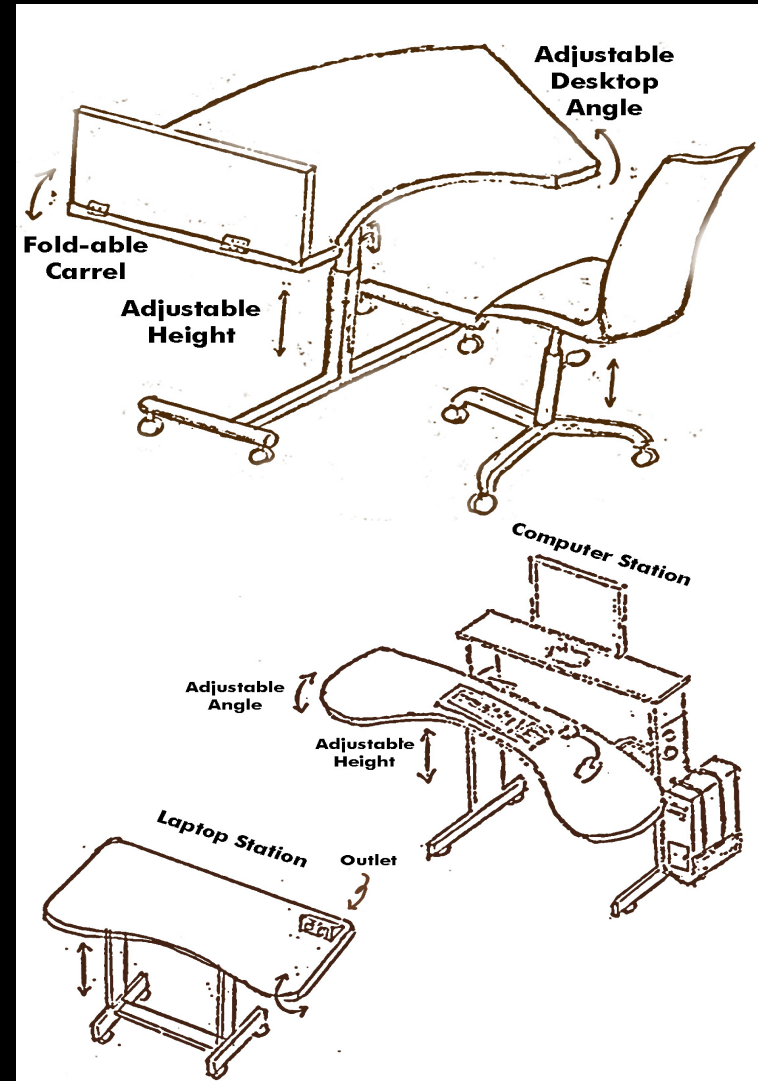
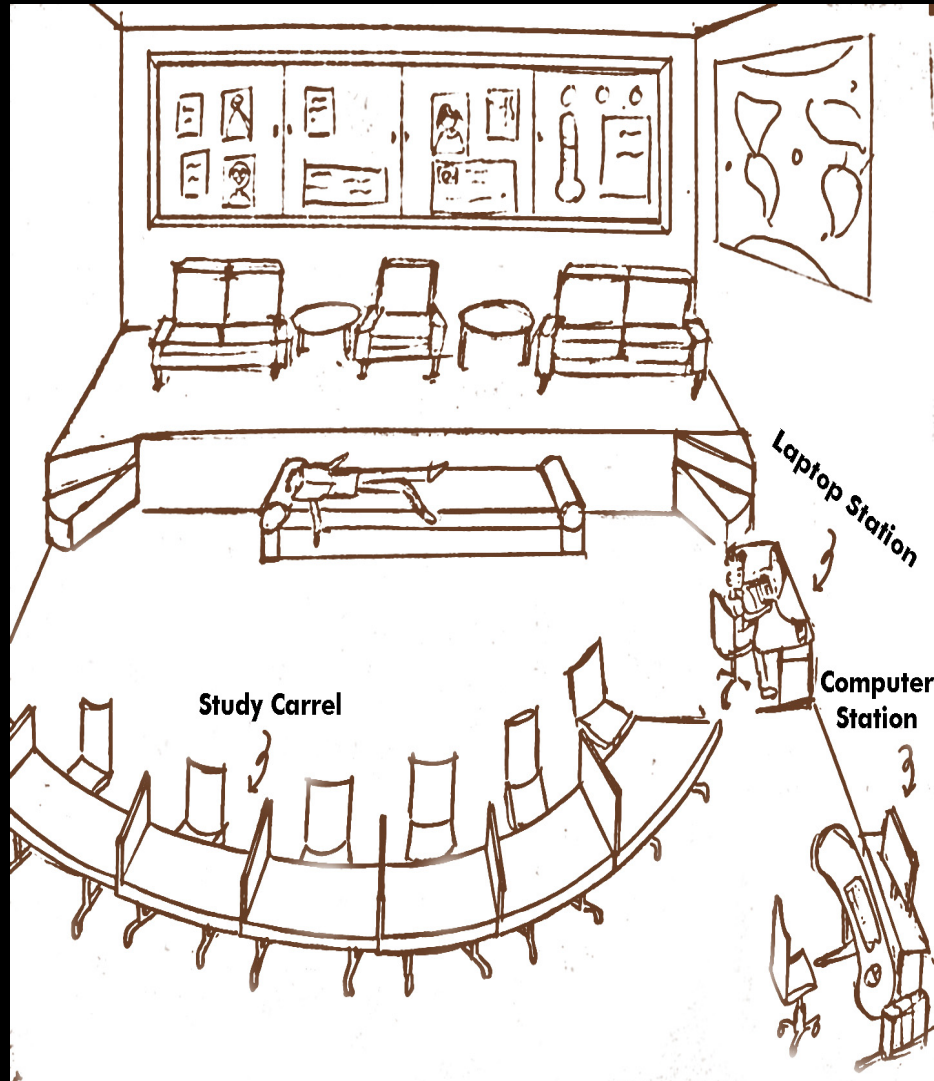

Level One

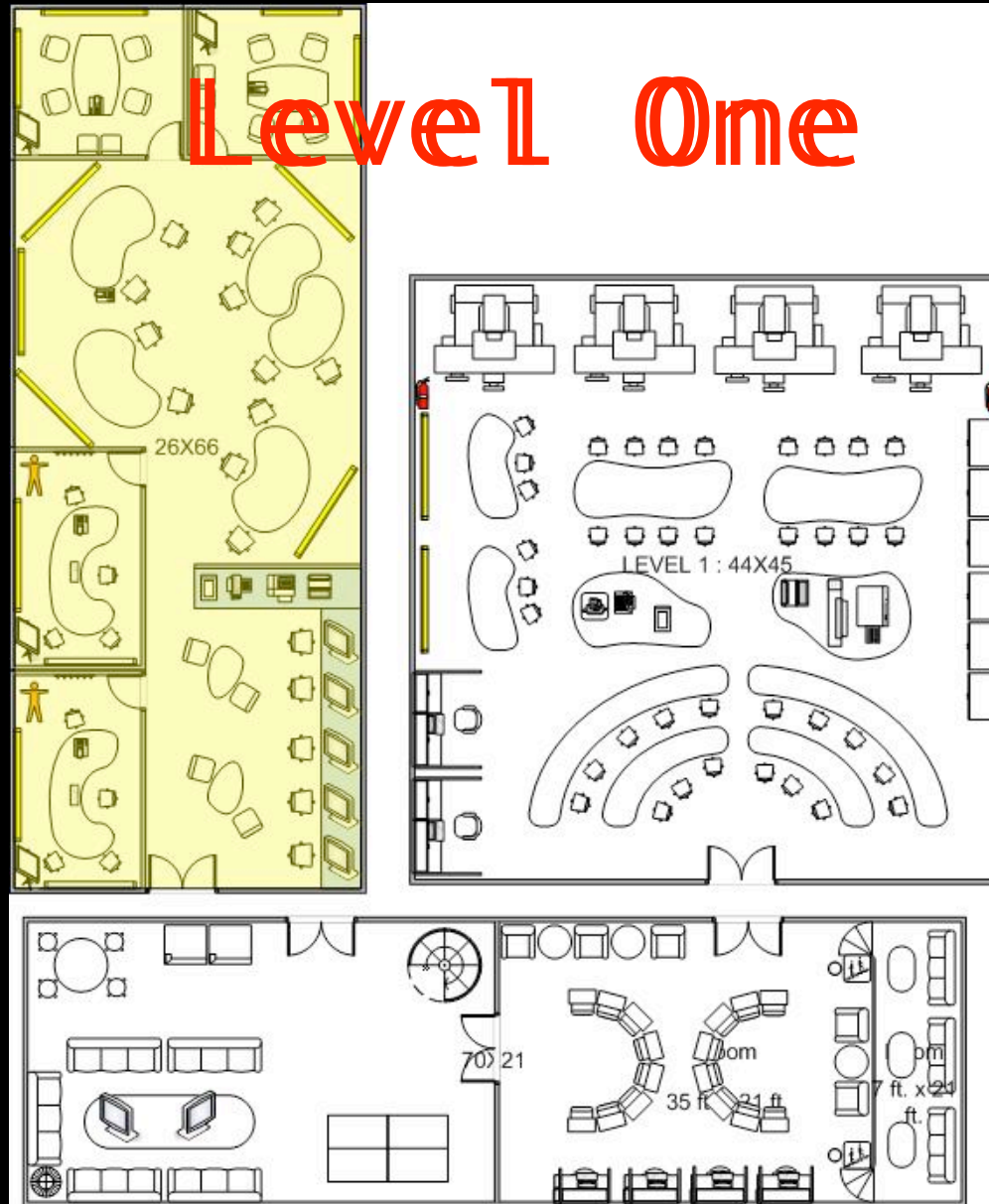

Group Work & Classes

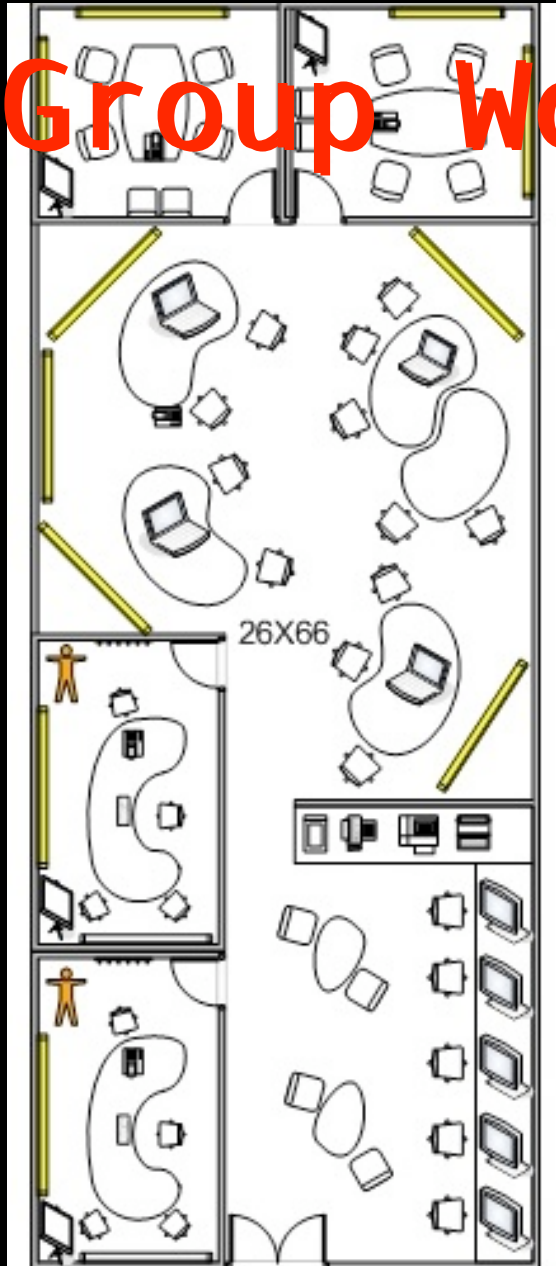

- * Space can be changed with partitions

- * Section for getting user feedback on prototypes

Awareness of others
Color blindness

Variety of spaces

Better work zones
Smart Board
Paper Roll
Pod-like tables

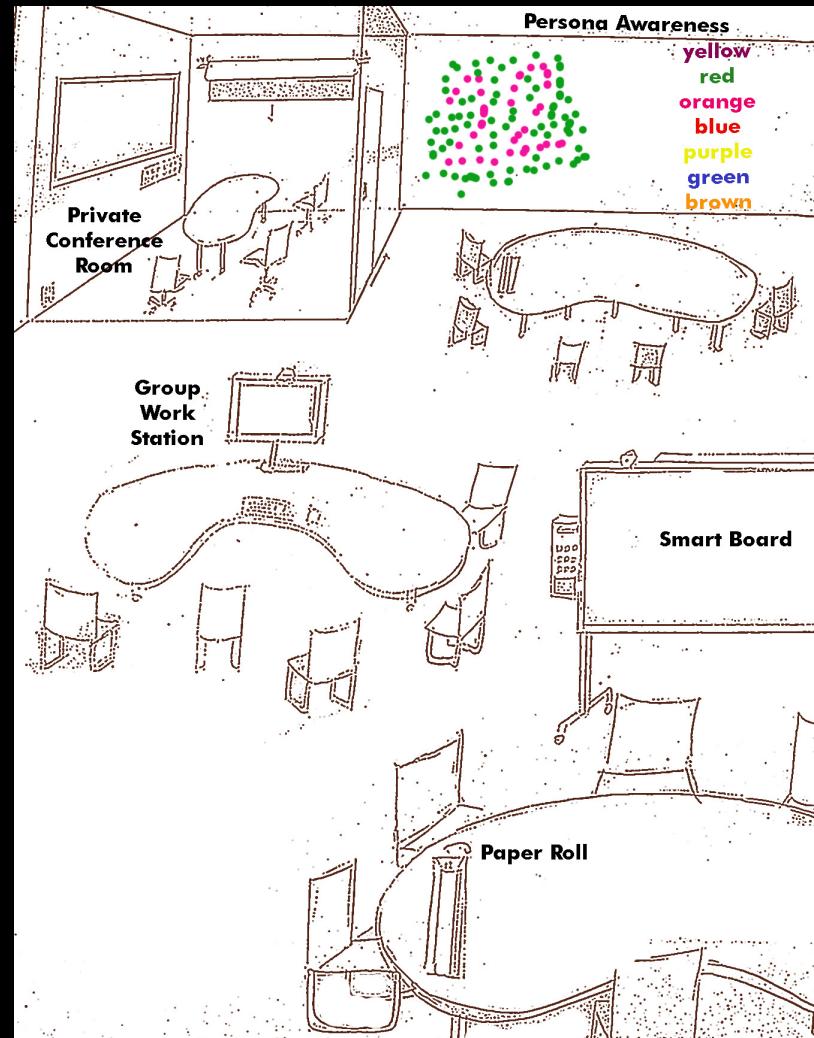

Level Two

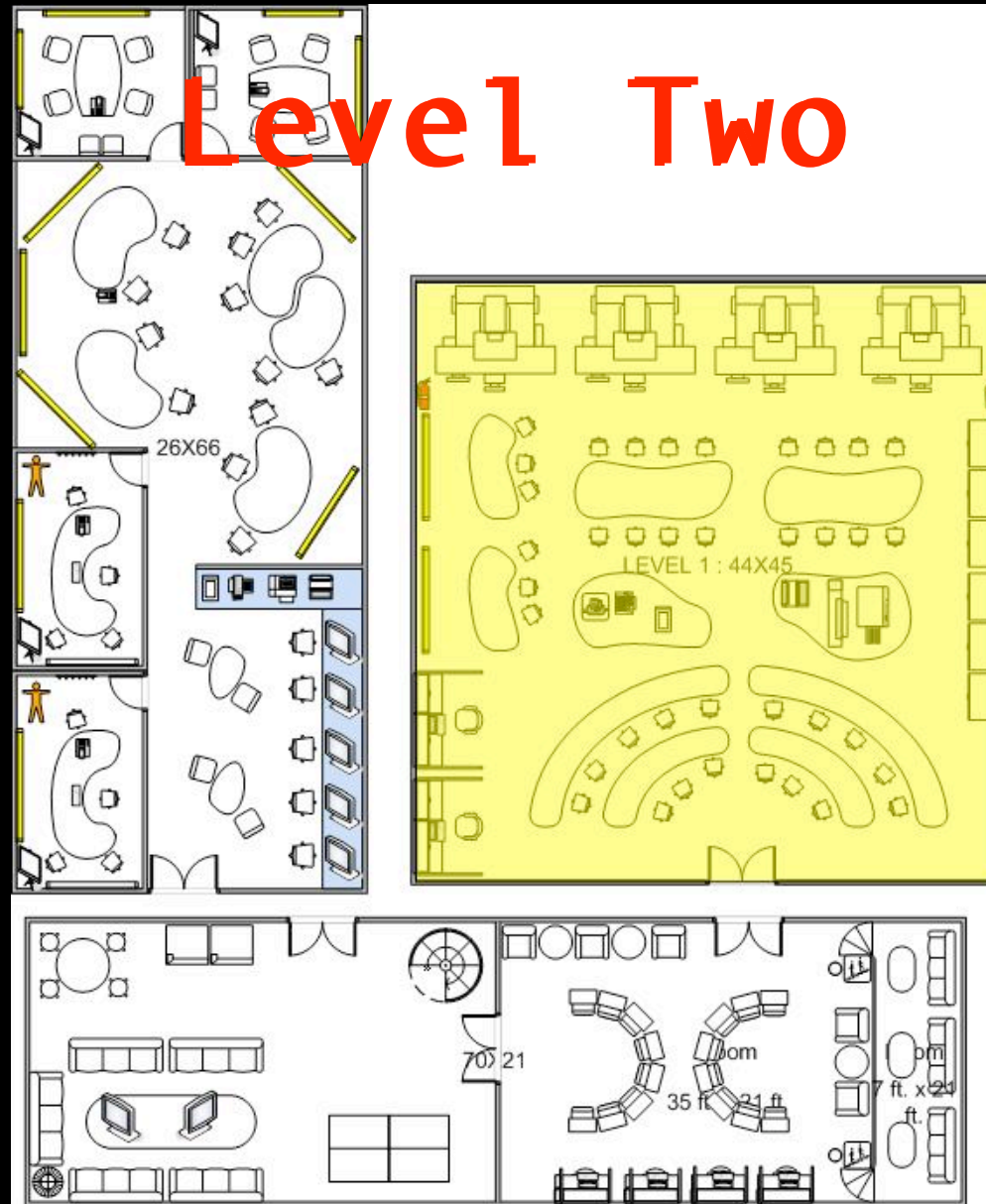

Prototyping Room

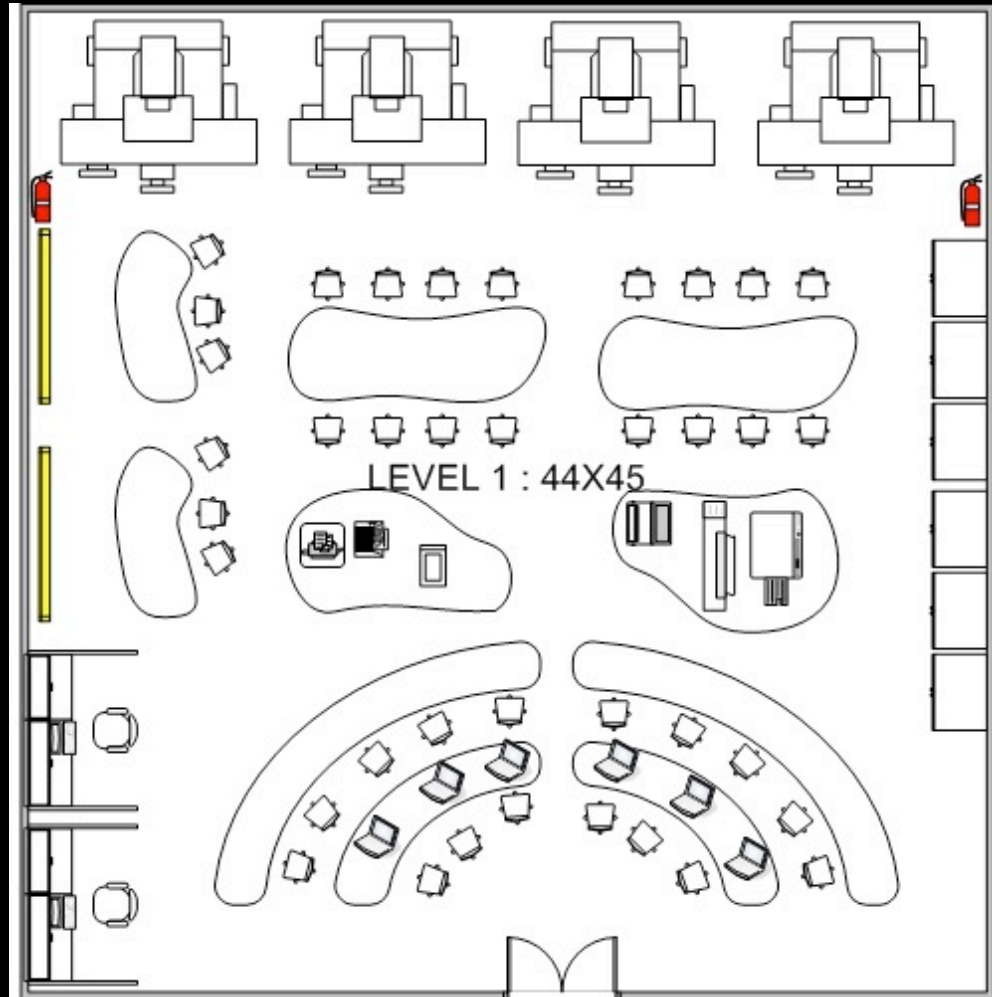

Machine Shop
Material Wall
Floor drains
Tool Wall

Basic Tools
Soldering irons
Wood cutting
tools, Laser Cutter
FDM
2 computers
Art supplies

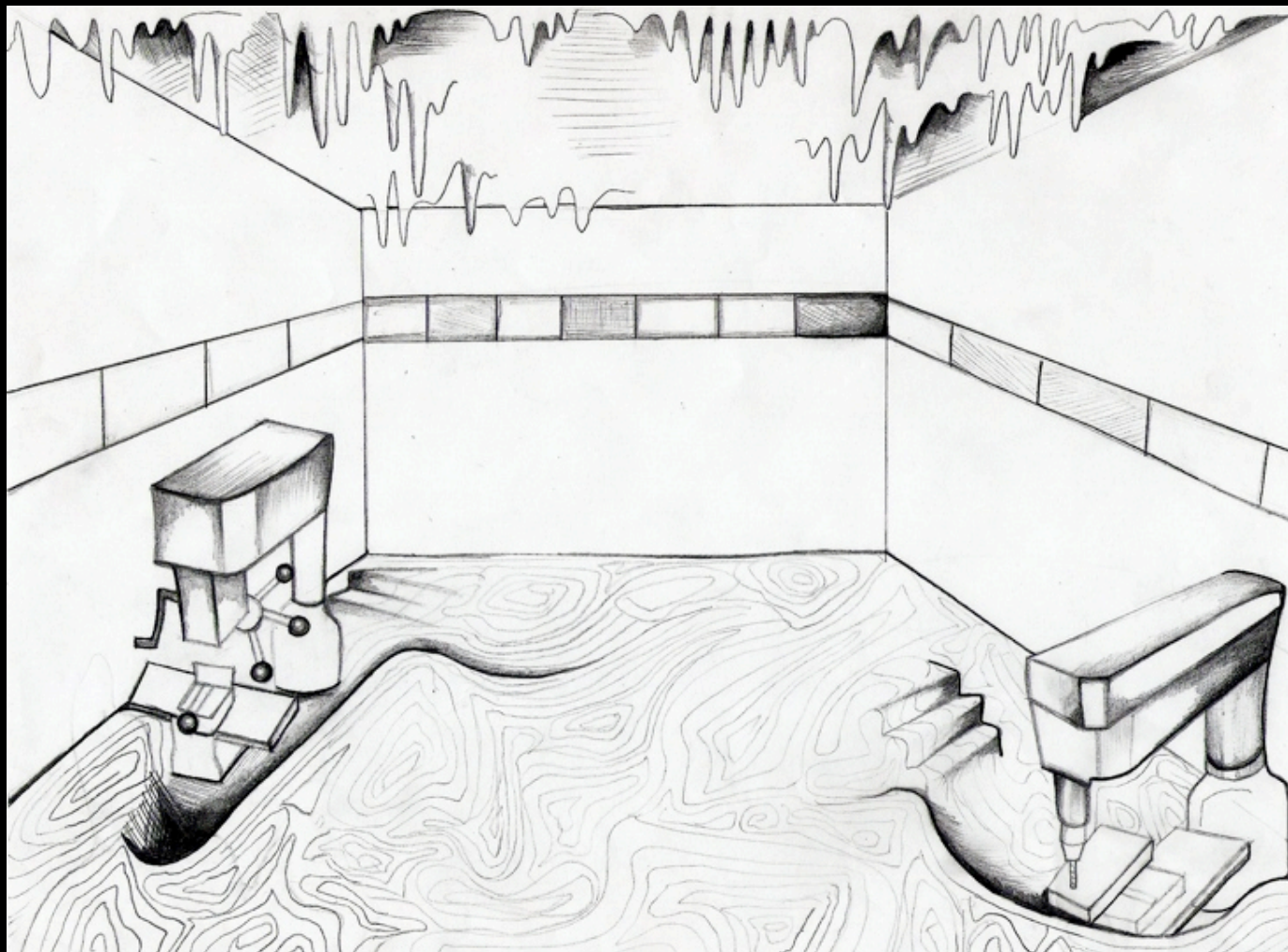

Material Wall

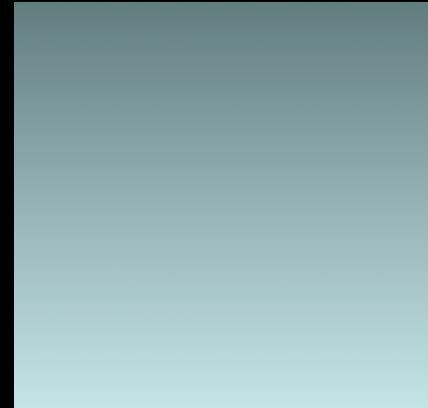
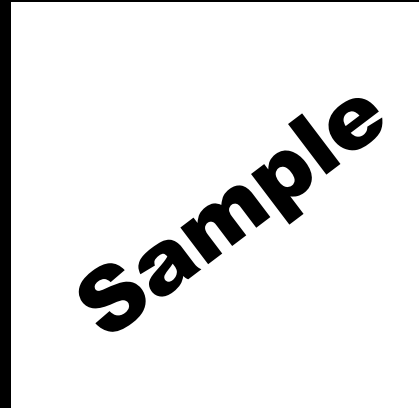

sample name

aluminum 1100-0

Density

2.71 g/cc

UTS

89.6 Mpa

E

68.9 Gpa

k

222 W/m-K

Metals, Ceramics & Plastics

Cyber Cafe

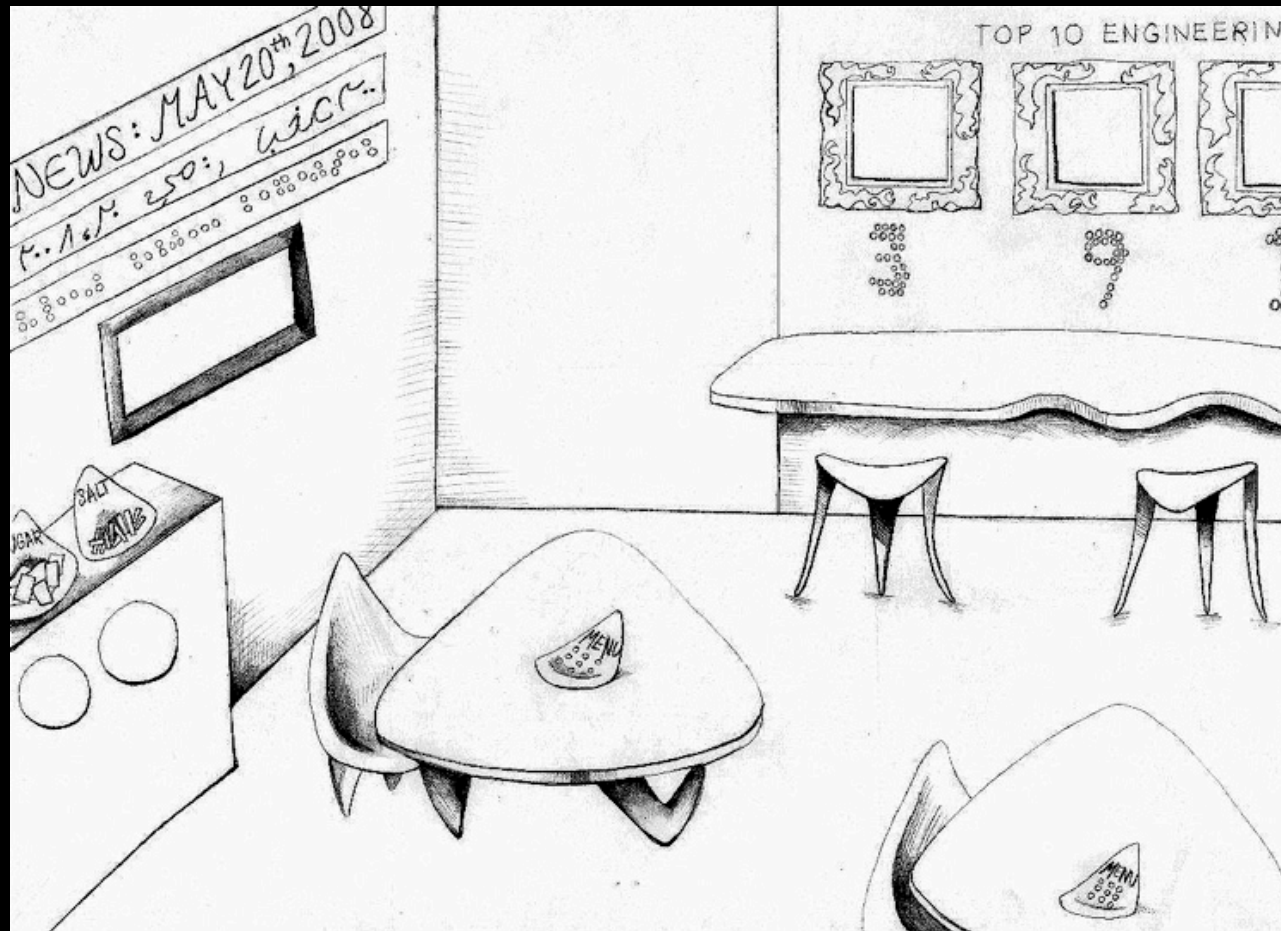

In Summary

- * Blurring lines: between lab users and lab space, and between product designers and product users
- * Create a practical, functional, and interesting space on the Berkeley campus

Thank you!